

Standard Inverted Top
& Bottom End Channels

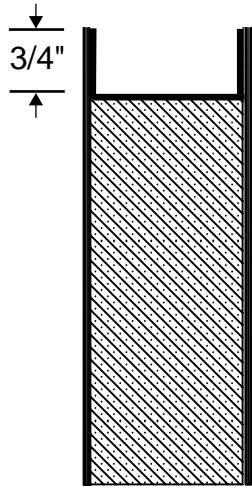

Optional Removable
Closed Top, Attached
With Screws

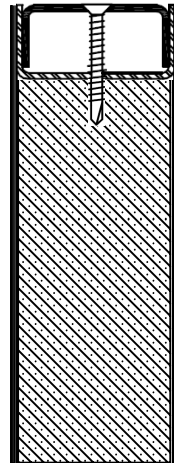

Both Sides of Door 18, 16 or 14 Gauge
A60 Galvanneal Only

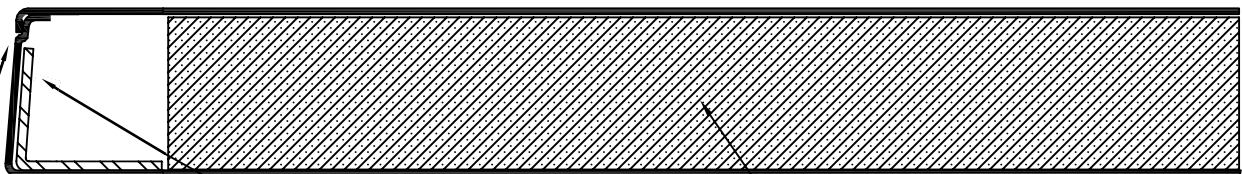

Welded Edges
Beveled Edge is Standard
Square Edge Optional

Hinge Reinforcement

Polystyrene Core

Maximum Width is 4'-7"
Maximum Height all Gauges is 120"
Label not available in Polystyrene Core Doors



Karpen Steel
Custom Doors & Frames
181 Reems Creek Rd
Weaverville NC 28787
www.karpensteel.com

Tel: 828-645-4821
Fax: 800-851-2131

Revised by: Z HENKEN

Customer name:

1 3/4" Thick Polystyrene Door

Job name:

Description:

Cross Section with Construction Details

File name:

CUDM0015

REV

Revision Date:

20FEB24

Sheet