

Right Hand

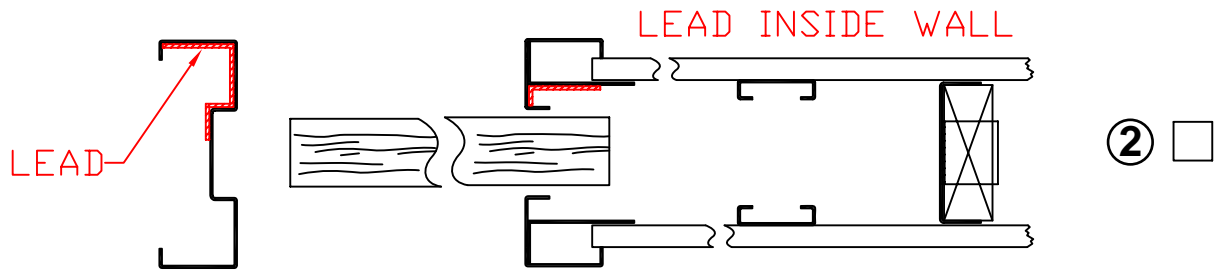

Left Hand

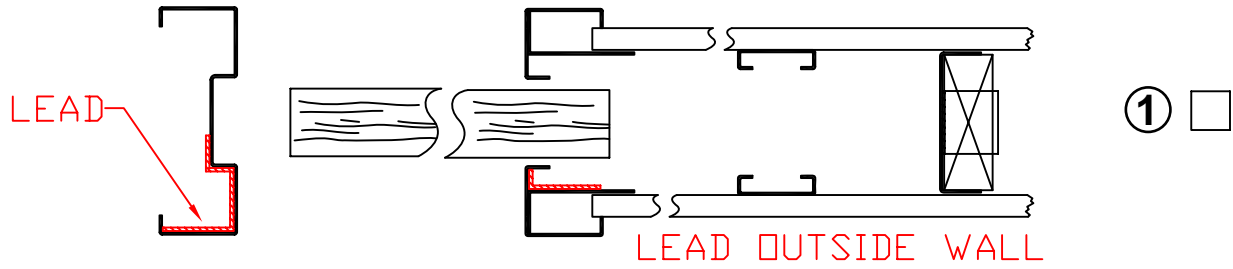
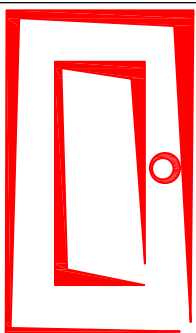
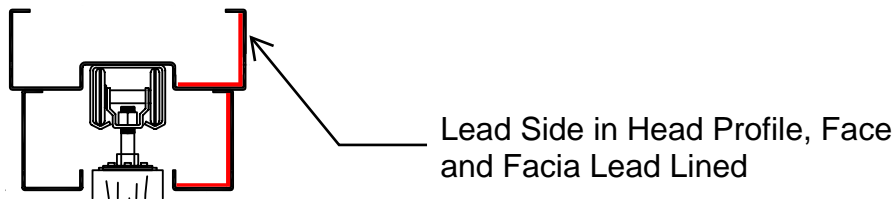
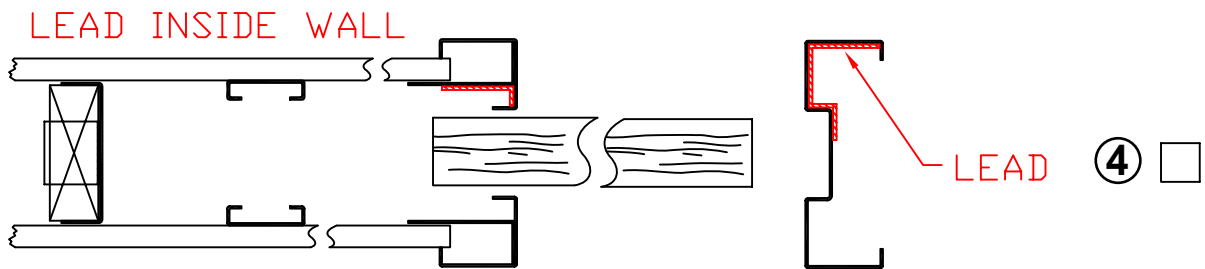
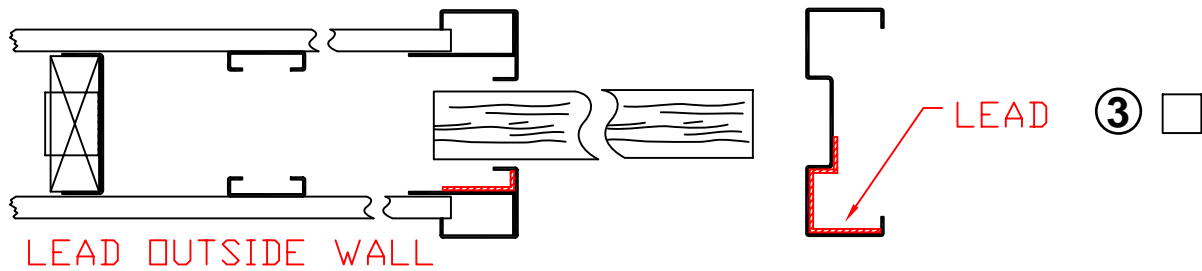

<p>Karpen Steel Custom Doors & Frames</p>	<p>Title: Lead Lined Pocket Frame Options</p>	
<p>181 Reems Creek Rd Weaverville NC 28787 www.karpensteel.com</p>	<p>Description: Check off Handing Required and Return to Karpen Steel Products</p>	
<p>Tel: 828-645-4821 Fax: 800-851-2131</p>	<p>File name: CUFK0006</p>	
<p>Drawn/Revised by: D SMITH</p>	<p>Rev. Date: 24OCT09</p>	<p>Revision</p>