

Spot Welded
All Four Sides

Drill & C'sink
#12-24 x 1/2 FHPSMS

14 GA Reinforcement

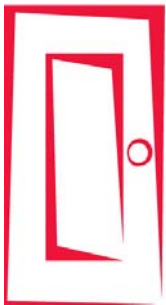
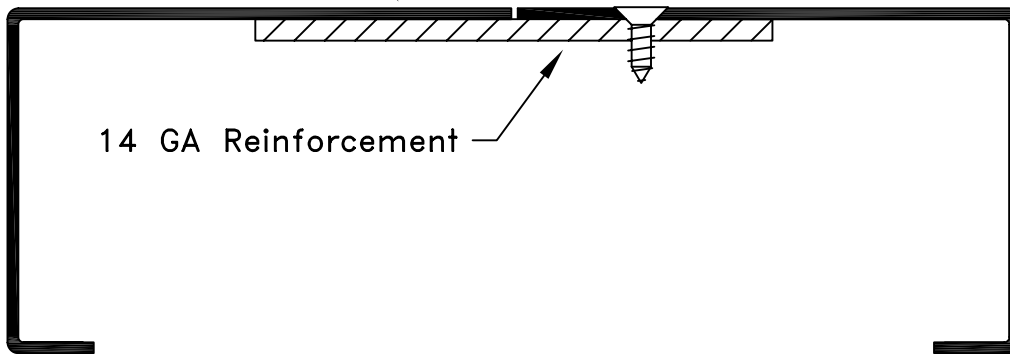

Karpen Steel
Custom Doors & Frames
181 Reems Creek Rd
Weaverville NC 28787
www.karpensteel.com

Customer name:

Job name:

Description:

Cased Open Slip Frame

Tel: 828-645-4821
Fax: 800-851-2131

File name:

CUFP0009

REV

Revised by:

B Blevins

Revision Date:

14MAR02

Sheet